

Tapered Socket Well Assemblies

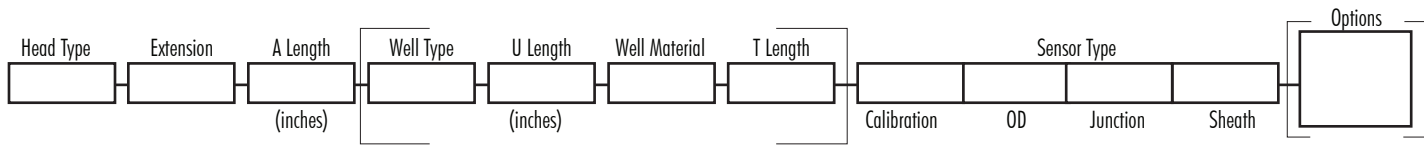

To order: To specify a complete assembly, indicate the code letter or value for each requirement. To order a well only, fill in only the boxes in brackets. Add a nipple or nipple-union-nipple to a well by including the extension code and "A" length in addition to the well codes.



HEAD TYPE

0	No Head	FTP	Flip Top Poly (white)
CA	Cast Aluminum	EPA	Explosion Proof Aluminum
CI	Cast Iron	EPAA	Explosion Proof Aluminum Atex
CSS	Cast Stainless Steel	EPS	Explosion Proof Stainless Steel
PPS	Polypropylene Sanitary	EHA	Explosion Proof Aluminum
FTA	Flip Top Aluminum	EHI	Explosion Proof Iron

EXTENSION

N	Nipple Galvanized
NUN	Nipple/Union/Nipple Galvanized
NS	Nipple Stainless Steel
NUNS	Nipple/Union/Nipple Stainless Steel
HUNS	Hex Nipple/Union/Nipple Stainless Steel
PNUN	Pressure Seal in Union Galvanized
PNUNS	Pressure Seal in Union Stainless Steel

See page A-7 for additional information.

THERMOWELL

Type	Pipe Size Nominal	Actual Dia. (P)	OD1	OD2
SWT**	1/2"	0.840	0.680	0.625
SWT0	3/4"	1.050	0.875	0.625
SWT1	1"	1.315	1.0	0.625
SWT2	1 1/4"	1.66	1.250	0.75
SWT3	1 1/2"	1.90	1.375	0.875
SWT4	2"	2.375	1.75	1.250

Note: To fit 3,000 lbs coupling.

** Instrument connection equals 1.062" O.D.

Well Materials – For other materials, see page B-6.

A	Alloy 600	I	Alloy 800	Q	310SS
AA	Alloy 20	LL	F91	R	316SS
B	Hastelloy® B	LP	Low Carbon 304SS	S	Carbon Steel
C	Hastelloy® C	LR	Low Carbon 316SS	T	Teflon®
D	321SS	M	Monel® 400	V	Alloy 825
F	347SS	N	Nickel	W	Alloy 601
H	446SS	P	304SS	Y	Brass

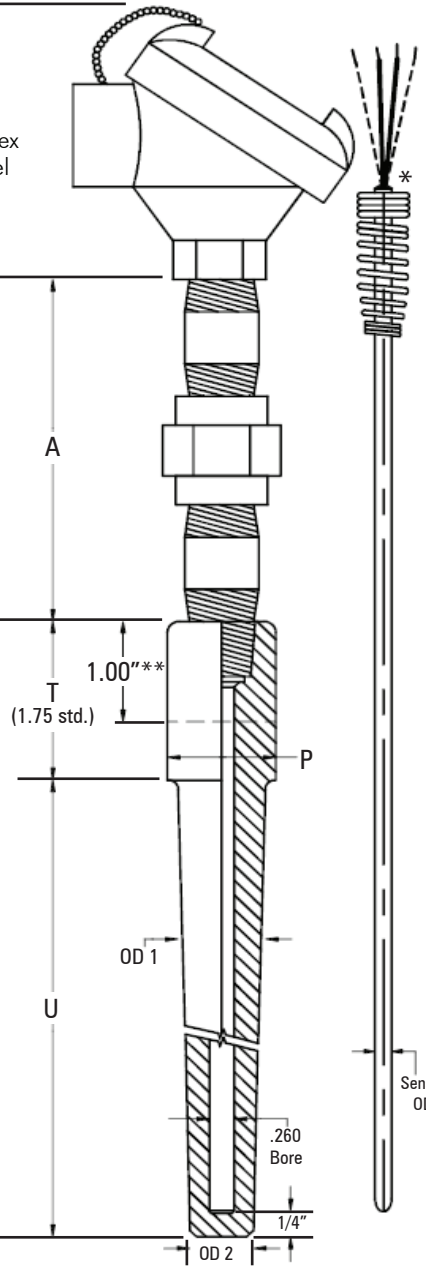

SENSOR TYPE

Sensor Calibration

J	Iron Constantan®
K	Chromel® Alumel®
T	Copper Constantan®
E	Chromel® Constantan®
N	Nicrosil® Nisil®
PO	Low Temp RTD to 500° F
PH	High Temp RTD to 900° F
PM	Heavy Duty RTD to 900° F

Standard RTD is a three-wire 100 ohm Platinum / .00385 Alpha. For higher temperature ranges - consult factory. For special limits on thermocouples, repeat calibration code, i.e. JJ.

Sensor OD

316	3/16"
14	1/4"
516	5/16"
38	3/8"

Sensor Junction

G	Grounded
U	Ungrounded
E	Exposed
DG	Dual Grounded
DU	Dual Ungrounded
DE	Dual Exposed
S	Single RTD
D	Dual RTD

Sensor Sheath Materials

P	304SS
R	316SS
Q	310SS
A	Alloy 600

Standard Sheath Material is 316SS.

* Epoxy Seal - Max. Temp. 300°F

OPTIONS

Sensor Options

GA	Class A
FW	Four Wire RTD
HV	High Vibration RTD (PM only)
CR	Cryogenic RTD (PM only)
CT	Compensated Terminals (EHA/EHI head only)

Thermowell Options

HTE	Hydrostatic Pressure Test External
HTI	Hydrostatic Pressure Test Internal
NC	NACE Certification for Well
OC	Oxygen Cleaned
ST	Stellite® Coating
TF	Teflon® Coating

TC	Tungsten Carbide
VC	Velocity Calculations
BC	Brass Plug and Chain
SC	SS Plug and Chain
WB	.385 Bore

If other than .385 Bore is required, specify bore size.

Transmitter/Indicator Options

LCP	Programmable, RTD, FM
PT	Programmable FM
HC	Hart® Compatible
Provide Range and Temp F/C	
See pages A-33 – A-34 for additional transmitter information.	
LPI	Loop Temperature Indicator
See pages A-33 – A-34 for transmitter and other options.	
BPI	Battery Powered Indicator